



Outstanding
material with
limitless
capability.

AESTHETICS IN
LIMITLESS

PT. Radin Mitra Lestari

Ruko Villa Bukit Mas
Jl. Wahab Siamin Blok RM No. 27
Surabaya 60225 - Indonesia
Telp. 031-99533330

✉ hello@re-holz.com

🌐 www.re-holz.com

📷 [re_holz](https://www.instagram.com/re_holz)



SCAN
TO SEE
DETAIL

More than Wood

Outstanding material
with limitless capability
is now available for you
to explore.



SCAN
TO SEE
DETAIL



We provide innovative material for design and building solutions.

PT. Radin Mitra Lestari (ReHolz) has the vision to introduce a material that can help architects and designers to create limitless design possibilities. ReHolz strive to create collaboration with our clients by bringing outstanding material experience and excellent service.

Awards



Certification



INTRODUCING RESYSTA

Using materials sourced from nature, ReHolz made of Resysta is highly sustainable.



Rice
Husk

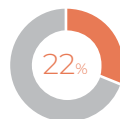

Common
Salt



Mineral
Oil

“This is a part of our ongoing commitment to maintain and support nature preservation.”

















Recycling Upcycling

By producing these sustainable materials, we hope to be able to participate in protecting our Earth's natural habitat and its sustainability for the next generation.

ReHolz prioritizes creative inventions, functions and environmental stability.

Technology has enabled us to create a material much more flexible and durable than wood, environmentally friendly and sustainable. Through our consistency in quality and innovation, we hope to create an impact and to help realize the greatest design creation.

Design Solution

Natural Looks		High in Durability			Green & Sustainable	
						
Colour	Texture	Termite Resistant	Seawater Resistant	Frost Proof	Recyclable Material	100% No Wood
Customizable						
Colour	Texture	Fire Resistant	Weather Resistant	Anti Fungal Damage	Low Maintenance	Barefoot Friendly
						
Shape		Very low degradable colour (6-7 years)				





Siegestor, Munich

01

Create Your Shape



Twisted



Bended

03

Color Creation



Basic Color



Premium / Custom
Color

02

Surface Finishes



Standard Surface



Standard Surface
with color



Deep Grains Surface

04

Diverse Application



Surface



Decorative



Structural Covering



Function

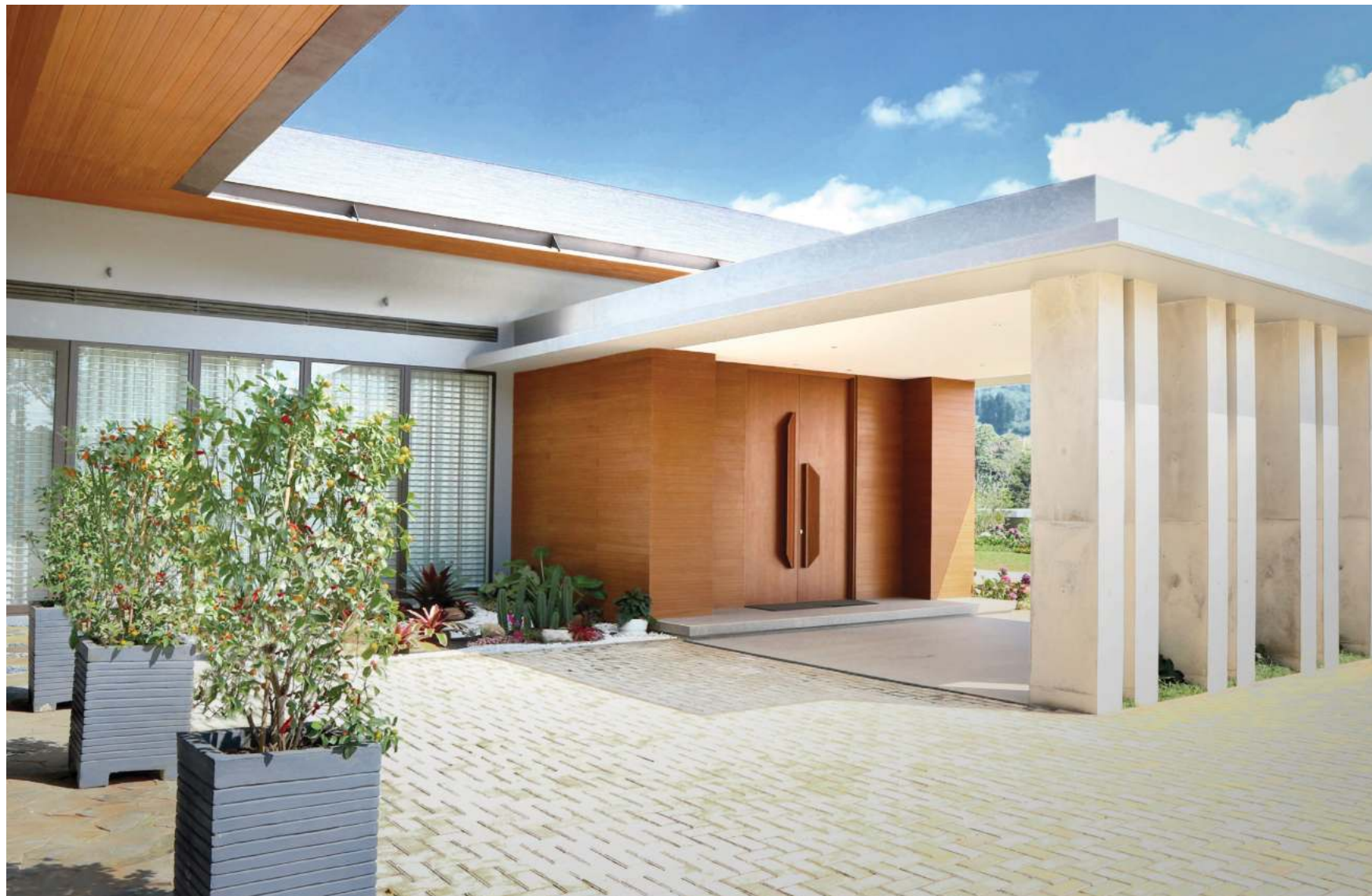



CLADDING SYSTEM

CP 95



Size (mm)
95 x 14 x 2900

CPSS25



CP 140



Size (mm)
140 x 14 x 2900

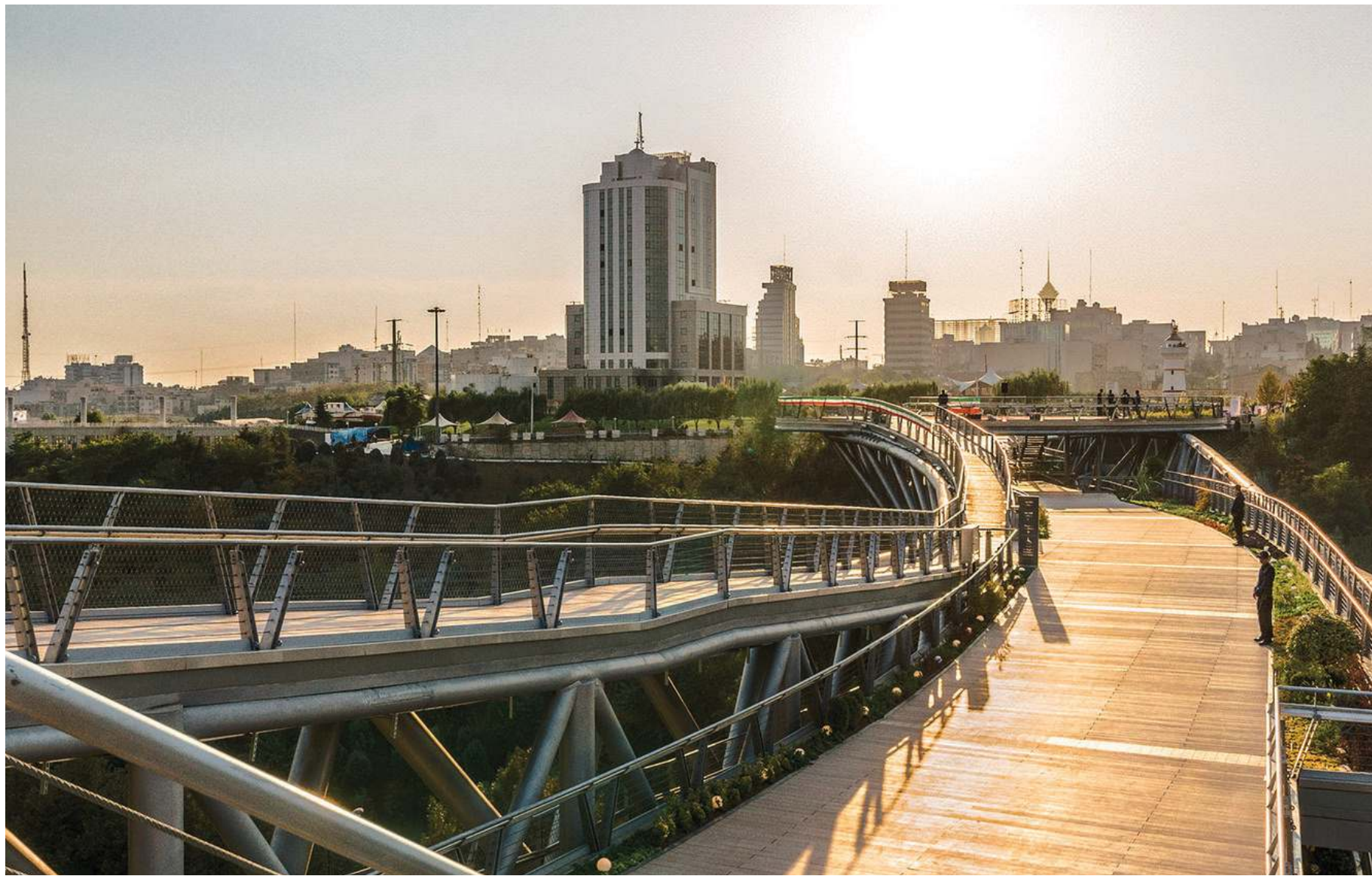

DECKING SYSTEM

DKG 14038



Size (mm)
140 x 38 x 2900

RUS 5528



Size (mm)
55 x 28 x 2900

RUH 3825



Size (mm)
38 x 25 x 2900

DKG 14025



Size (mm)
140 x 25 x 2900

Clip T4







UNIVERSAL PROFILE SYSTEM

FPH 5528



Size (mm)
55 x 28 x 2900

FPH 7020/3.5



Size (mm)
70 x 20 x 2900

FPHR 6250



Size (mm)
65 x 20 x 2900

UNIVERSAL PROFILE SYSTEM

		<div>FPH 9015</div> <div></div> <div>Size (mm) 90 x 15 x 2900</div>	<div>FPH 7038/3.5</div> <div></div> <div>Size (mm) 70 x 38 x 2900</div>
<div>HR 6040</div> <div></div> <div>Size (mm) 60 x 40 x 2900</div>	<div>FPH 7038/8</div> <div></div> <div>Size (mm) 70 x 38 x 2900</div>	<div>FPH 14020</div> <div></div> <div>Size (mm) 140 x 20 x 2900</div>	<div>HR 12050</div> <div></div> <div>Size (mm) 120 x 50 x 2900</div>
<div>FPH 7020</div> <div></div> <div>Size (mm) 70 x 20 x 2900</div>	<div>FPH 10050</div> <div></div> <div>Size (mm) 100 x 50 x 2900</div>	<div>FPH 14020</div> <div></div> <div>Size (mm) 140 x 20 x 2900</div>	<div>ARO 180</div> <div></div> <div>Size (mm) 180 x 44 x 2900</div>

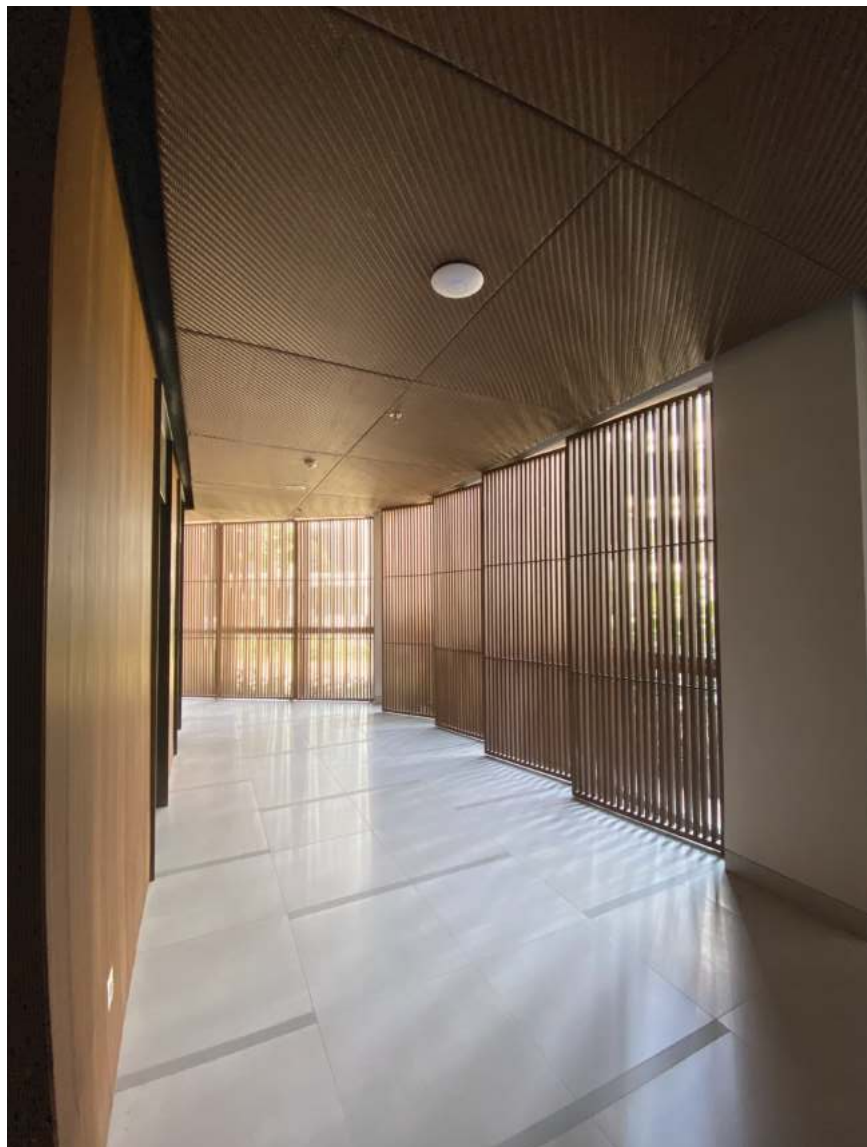

UNIVERSAL PERFORMANCE BOARD

Water-resistant + Product
USP diatas

Water-resistant panel
with the natural look and
feel of wood

Reholz UPB sheet can be processed with
conventional woodworking machines. Easy miling,
sawing, screwing, and nailing

Dimension available:

Thickness (mm)	Width x Length (mm)
8	1220 x 2440
12	1220 x 2440
16	1220 x 2440
20	1220 x 2440

Applications
**Flooring • Panel System • Wall
Cladding and more possibilities**



UPB 12 mm
Tongue & Groove



UPB 8 mm
Half - Lap



One board with infinite use,
it is applicable in any design
environment and providing
possibilities for different
color concept.

REHOLZ MATERIAL

LOW-RISE APPLICATION

1. Ceiling - Interior Cornice
2. Wall Cladding
3. Ceiling
4. Custom Panel for Facade
5. Decorative Wall Panel
6. Decking
7. Column Wrap



REHOLZ MATERIAL

HIGH-RISE APPLICATION

1. Ceiling - Indoor & Outdoor
2. Custom Panel for Facade
3. Wall Cladding
4. Canopy Screen



TECHNICAL SPECIFICATION

Density	ASTM D2395:2002	Approx. 1.46 kg/m ³
Coefficient of Liner	ASTM D696	3.6x10(-5)mC
Thermal Expansion		
Water Absorption Air	ASTM D1037:2006a	none or very low water absorption (only surface wetting)
Humidity Behaviour		
Weathering and EV Resistance	QUV Test	Resysta surface treated with glaze show extremely high resistance
Skid Resistance	DIN 51097	C Rating (Highest Rating)
Fire Behaviour	EN ISO 11925-2	B2 normal inflammable (with additives B1 can be achieved)
(German Standard)		
Fire Behaviour (US Standard)	NFPA	A rating (flame propagation 25, smoke emission 450)
Fire Behaviour (British Standard)	BS 476 Part 6&7	Rating 1
Durability (Resistance to wood	DINV ENV 12038:2002	The material has not been affected, highest
Destructive Fungi)		durability-Class 1
Emission	DIN EN ISO 9001/14001	Passed
Brinell Hardness (HB)	EN 1534	81,1 N/mm2
Friction Coefficient μ untreated	EN 13893	0,46
Friction Coefficient μ with 2K varnish	EN 13894	0,52
Screw withdrawal Resistance	EN 320.2011-07	5777 N
Heat Conductivity (λ)	EN 12664	0.199 W/(mK)
Water Vapour Permeability	DIN EN ISO 12572	$\mu=1300 \rightarrow$ sd 7.22m diffusing inhibiting
Bending Strength	ISO 178	46 N/mm2
Bending Modulus	ISO 178	3850 N/mm2
Tensile Strength	ISO 527	21.8 N/mm2
Tensile Modulus	ISO 527	2340 N/mm2
Shearing Strength	EN 392	16.8 N/mm2
Resistance to Mould Fungal Decay	CENT/TS 15083-2	The material features almost no mass loss, highest durability classification 1 (very durable)
Resistance to Termites	ASTM D3345-08	Resistant to terminate infestation (coptotermes curvignathus), very little loss of mass - very high durability
Electric surface resistance and volume resistivity	Specific surface resistance and volume resistivity	Surface resistance Rx=8.0*10(13) Ω Specific surface resistance A=8.1*10(14) Ω Volume resistance Rx=2.2*10(13) Ω Specific volume resistivity A=6.3*10(14) Ω

Globally renowned institutions carry out test according to German, British, European and US standards.





ONE MATERIAL
UNLIMITED
POSSIBILITIES

Velden,
Austria, 2014

DECKING SYSTEM

DKG 14025

Size (mm) 140 x 25 x 2900



St. Martin im Passeiertal.
Italy, 2009

DECKING SYSTEM

DKG 14025

Size (mm) 140 x 25 x 2900





Ocean Drive,
Miami, USA

DECKING SYSTEM

DKG 14025
Size (mm) 140 x 25 x 2900



Florida, 2015

Universal Profile System

FPH 7020/3.5
Size (mm) 70 x 20 x 2900

Sunset House,
USA, 2021

DECKING SYSTEM

DKG 14025

Size (mm) 140 x 25 x 2900

Cladding System

CP 140

Size (mm) 140 x 15 x 2900





Ocean Drive
Miami, USA

DECKING SYSTEM

DKG 14025
Size (mm) 140 x 25 x 2900



Villa Coolibah
Bogor, 2021

Universal Performance Board

UPB 8mm
Size (mm) 8x 1220 x 2440



Park Hyatt
Jakarta, 2020

Universal Profile System;
Custom Panel; FPH 7020/3.5;
Size (mm) 70 x 20 x 2900









GC House
Makassar, 2022

Ceiling System
CP 140

Universal Profile System
FPH 10050

Universal Profile System
FPH 7020

Custom Main Gate





EFJ House
Surabaya, 2021

DECKING SYSTEM

DKG 14025
Size (mm) 140 x 25 x 2900

Lee Residence
Surabaya, 2021

DECKING SYSTEM

Universal Performance Board;
Cladding System;

UPB 8mm

Size (mm) 8 x 1220 x 2440

UPB 16mm

Size (mm) 16 x 1220 x 2440

Universal Profile System;

Custom Panel;

Laminated frame & FPH 7020/3.5;

Size (mm) 70 x 20 x 2900



